

S141U



Materials

- Stationary - Car / SiC / SSiC / TC
- Rotary - SiC / SSiC / TC
- Elastomer - NBR / EPDM / Viton / Atlas / FFKM

Working Conditions

- Pressure < 28 bar
- Speed < 25 m/s
- Temperature up to 205°C

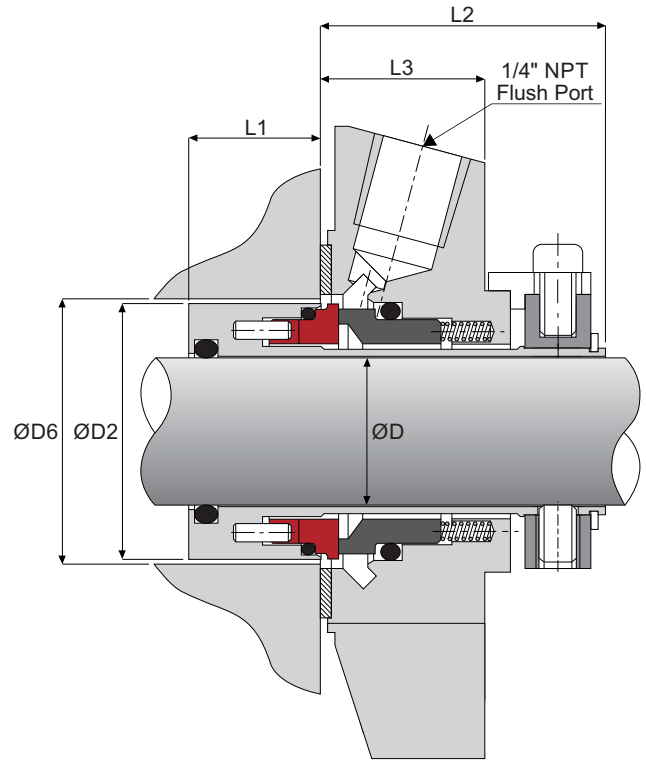

Features:

- Stationary Design
- Monolithic Faces
- Cushioned Faces
- Pressure balanced
- Springs outside the media

Gasket Sizes

ID = ØD2 + 2.5mm
OD = L5 - 1.5mm

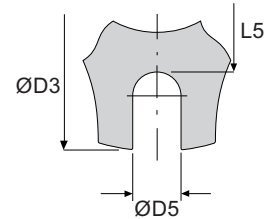

Inch ØD	Code	ØD2	ØD3	ØD5	ØD6 Min	L1	L2	L3	L5
1.000"	0254	39.9 (1.571)	105 (4.134)	12.5 (0.492)	41.27 (1.625)	18 (0.709)	38 (1.496)	21.5 (0.846)	62 (2.441)
1.125"	0286	43.1 (1.697)	106 (4.134)	12.5 (0.492)	44.45 (1.750)	18 (0.709)	38 (1.496)	21.5 (0.846)	62 (2.441)
1.250"	0317	46.3 (1.823)	107 (4.134)	12.5 (0.492)	47.62 (1.875)	18 (0.709)	38 (1.496)	21.5 (0.846)	65 (2.559)
1.375"	0349	49.5 (1.949)	108 (4.134)	12.5 (0.492)	50.80 (2.000)	18 (0.709)	38 (1.496)	21.5 (0.846)	67 (2.638)
1.500"	0381	55.3 (2.177)	115 (4.528)	12.5 (0.492)	57.10 (2.248)	18 (0.709)	38 (1.496)	21.5 (0.846)	70 (2.756)
1.625"	0412	58.3 (2.295)	125 (4.921)	14.7 (0.579)	60.30 (2.373)	18 (0.709)	38 (1.496)	21.5 (0.846)	75 (2.953)
1.750"	0444	62.3 (2.453)	133 (5.236)	14.7 (0.579)	63.50 (2.500)	18 (0.709)	38 (1.496)	21.5 (0.846)	80 (3.150)
1.875"	0476	65.3 (2.571)	140 (5.512)	14.7 (0.579)	66.60 (2.622)	18 (0.709)	38 (1.496)	21.5 (0.846)	81 (3.189)
2.000"	0508	68.5 (2.697)	141 (5.512)	14.7 (0.579)	69.80 (2.748)	18 (0.709)	38 (1.496)	21.5 (0.846)	84 (3.307)
2.125"	0539	71.5 (2.815)	150 (5.906)	17.5 (0.689)	73.00 (2.874)	18 (0.709)	38 (1.496)	21.5 (0.846)	92 (3.622)
2.250"	0572	76.5 (3.012)	160 (6.299)	17.5 (0.689)	78.00 (3.071)	19 (0.748)	38 (1.496)	21.5 (0.846)	100 (3.937)
2.375"	0603	78.5 (3.091)	161 (6.299)	17.5 (0.689)	80.00 (3.150)	19 (0.748)	38 (1.496)	21.5 (0.846)	100 (3.937)
2.500"	0635	81.5 (3.209)	165 (6.496)	17.5 (0.689)	83.00 (3.268)	19 (0.748)	38 (1.496)	21.5 (0.846)	109 (4.291)
2.625"	0666	86.5 (3.406)	166 (6.496)	17.5 (0.689)	88.00 (3.464)	19 (0.748)	38 (1.496)	21.5 (0.846)	109 (4.291)